

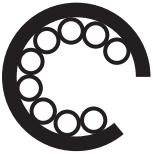

Stainless Steel Top



Corner Protection



Ball Bearing Slides



Key Lock

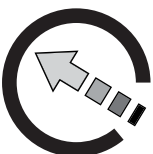

Soft Close Drawer



Edition : 1.0
Date: (12/24)

Instruction Manual

DELUXE SERIES ROLLER CABINET TDL-287

Order Code: (T6861)

TOOL TROLLEY

DELUXE SERIES



BEFORE ASSEMBLING

Please read this instruction manual before assembly.



CAUTION

Before assembly please pay attention to the following points in priority;

Confirmation of components: Before assembling, please confirm all parts arrived and are in good order.

Site for assembly: Please assemble it on the soft floor such as smooth carpet and flannel blanket. When you assemble on wooden floor, please put thin towels on the floor.

Points for attention when assembling: Please wear gloves to ensure that it can be assembled safely, and use two persons to help in the assembly process.

SAFETY INFORMATION

1. Do not pull this roller cabinet, push it when moving.
2. Engage both brakes when this roller cabinet is not being moved. This prevents the roller cabinet rolling away.
3. Secure this roller cabinet properly before moving with a forklift.
4. Do not tow this roller cabinet with power equipment.
5. Do not alter this roller cabinet in any manner. For Example. Do not weld external lock bars or attach electrical equipment.
6. Before locking the roller cabinet, ensure the drawers are completely closed in order for the lock bars to work properly.



CAUTION: Do not attach or mount this product to a vehicle. This may cause personal injury or product damage. Mounting this product to any vehicle in any manner will void warranty.



CAUTION: Keep the product on level surfaces. The product may become unstable and tip if stored or moved on an un-level surface, which may cause personal injury or product damage.



CAUTION: Do not stand on this product. You may fall which may cause personal injury or product damage.



CAUTION: Lock the drawers before moving this product. The drawers could come open and make the product unstable and tip, which may cause personal or product damage.



CAUTION: Be careful when opening more than one drawer. The product may become unstable and tip, which may cause personal injury or product damage.



TOOL TROLLEY

DELUXE SERIES



SPECIFICATIONS

Overall size: 722 x 482 x 848mm (LxWxH)

Overall with casters: 722 x 482 x 1013mm (LxWxH)

Package size: 770 x 530 x 990mm (LxWxH)

5 drawers: 570 x 410 x 75mm (30kg Per Drawer)

2 drawers: 570 x 410 x 153mm (30kg Per Drawer)

Nett Weight: 68kg

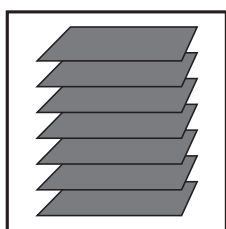
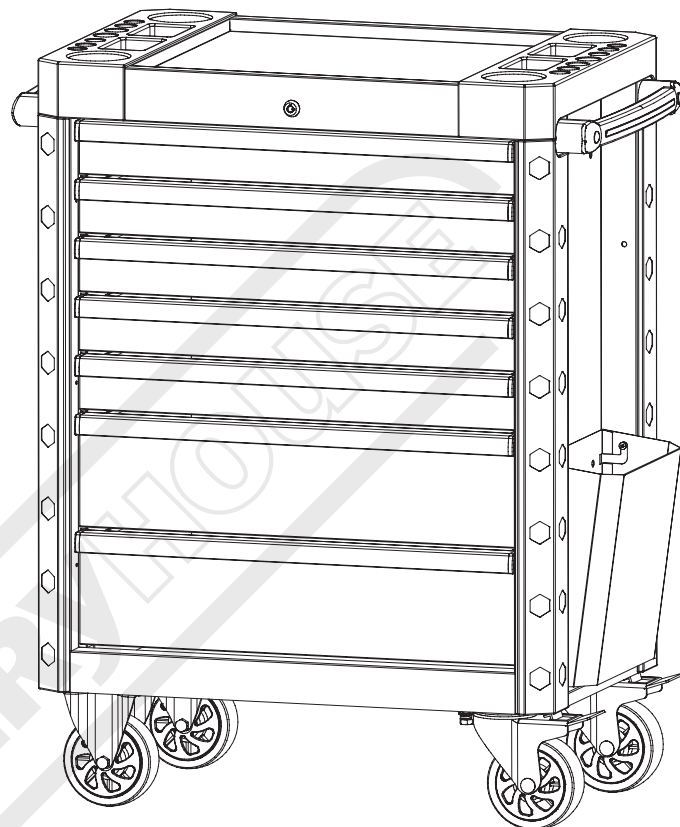

Drawer Liners (x7)



Swivel Brake
Wheels (x2)



Keys (x2)



Fixed Wheels (x2)



Trolley Handle
(x2)



Large Storage
Holder (x1)

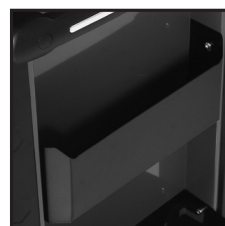

Small Storage
Holder (x1)



Paper Towel
Holder (x1)



M10x20mm
Bolts, Washers &
Spring Washers
(x16)



M6x55mm Cap
Head Screws,
Set Washers &
Plastic Caps (x4)



M5 x 15mm
Screws & Spacer
(x2)



10G x 15mm
Screws (x2)



M6x12mm Dome
Head Screws (x2)

TOOL TROLLEY

DELUXE SERIES

HAFCO

ASSEMBLY INSTRUCTIONS

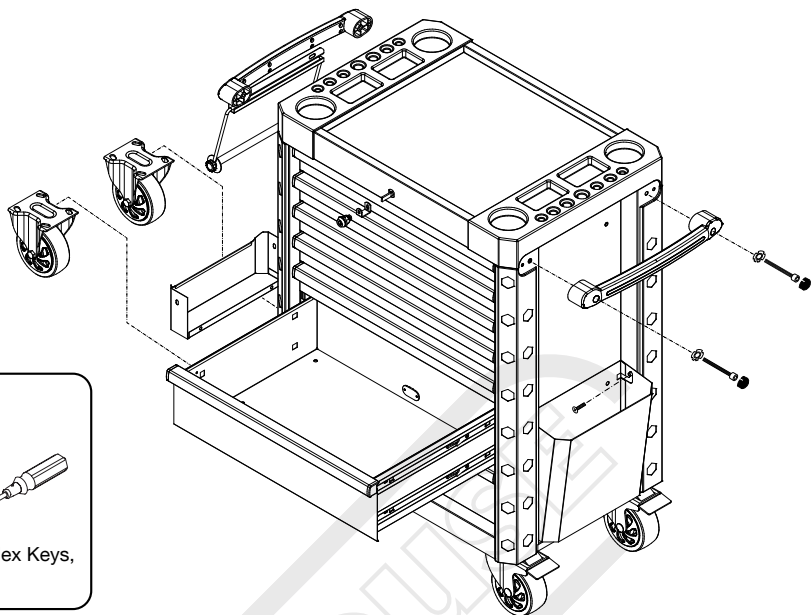

TOOLS & ASSISTANCE NEEDED

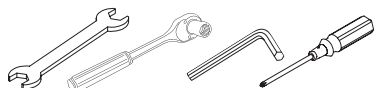

16mm spanner/socket, 4 & 5mm Hex Keys,
Philips Head Screwdriver

*Tools not included

STEP 1.

Handle Installation

- Position the side handles in-line with the holes on left & right sides of the roller cabinet.
- Attach with washers & M6x55mm screws and tighten with a 5mm Hex Key. Then press in the plastic caps as shown in Fig. 1.

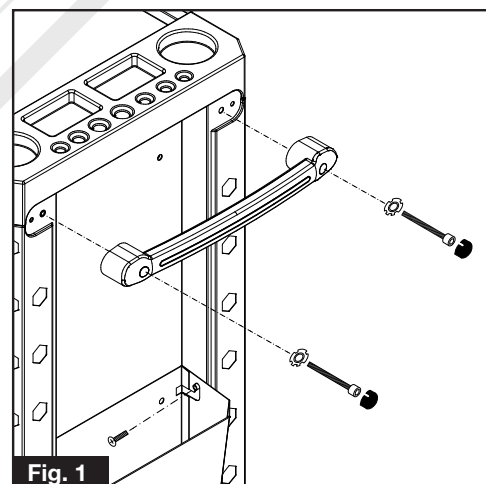

STEP 2.

Attaching the Wheels

- Be sure the drawers are locked and lay the cabinet on its top. Use packaging material or a blanket to protect the finish of the roller cabinet.
- Attach the swivel brake wheels to the base of the roller cabinet on the same side as the handle, using M10x20mm bolts, washers and spring washers as shown in Fig. 2. Tighten using a 16mm spanner/socket.
- Repeat this process for the fixed wheels on the opposite side of the roller cabinet.
- Return the roller cabinet to its upright position.

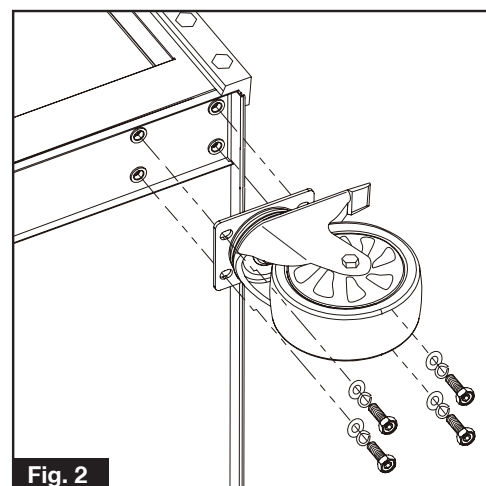

STEP 3.

Large Storage Holder Installation

- Fix the M5x15mm screws with spacers into position using a Philips head screwdriver on both sides. Then slide the large storage holder over the spacers via the slots in the back of storage holder as shown in Fig. 3.

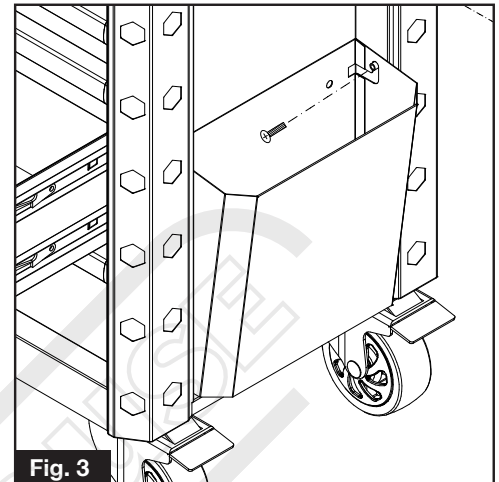

STEP 4.

Small Storage Holder Installation

- Position the small storage holder in-line with the holes on the roller cabinet. Can be mounted top of bottom on either side of the cabinet.
- Attach using 10Gx15mm screws and tighten with a Philips head screwdriver as shown in Fig. 4.

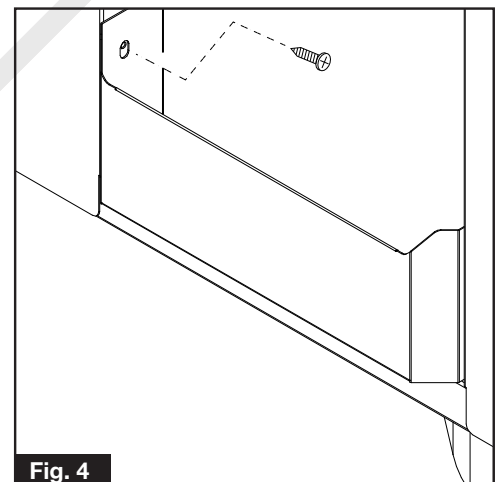

STEP 5.

Paper Towel Holder Installation

- Position the paper towel holder in-line with the holes on top side of the roller cabinet.
- Attach with 2x M6x12mm screws and tighten using a 4mm hex key as shown in Fig. 5.

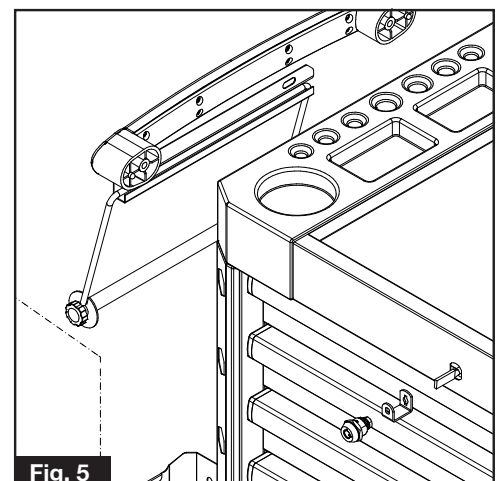

OPERATION

1.

Removing the drawers

- Fully extend the empty drawer.
- Push up the one release lever while pulling down on the other release lever.
- Pull the drawer outward until it is released from the drawer slide.

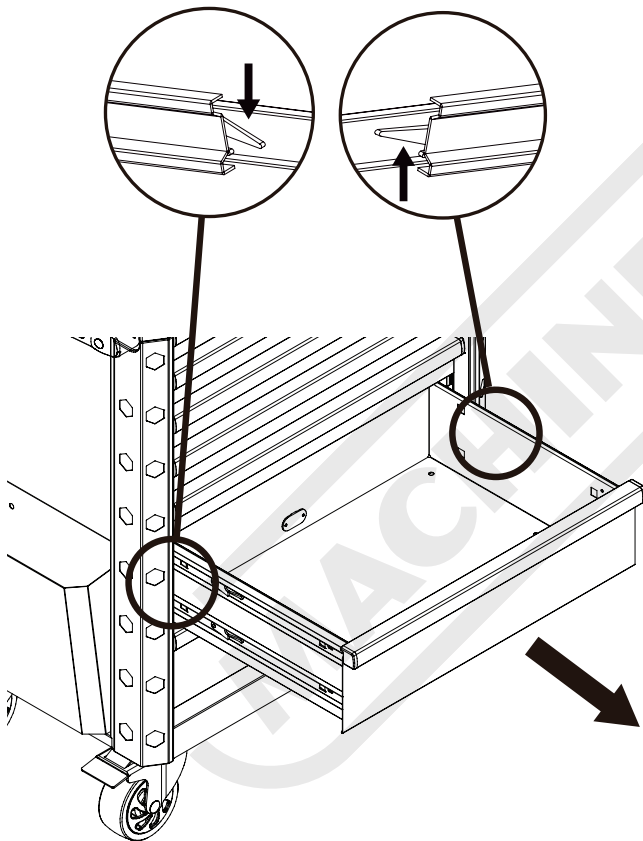

2.

Re-inserting the drawers

- Extend the drawer slides.
- Insert the brackets on each side of the drawer into the slots in the slides, being careful that they are properly positioned.
- Once properly inserted, completely close the drawer to set the slides in their proper positions and make sure you go all the way in to engage the firm close drawer system.

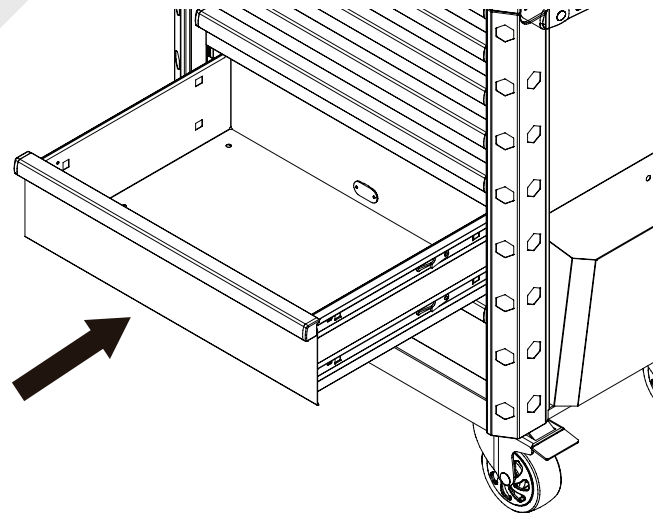

MAINTENANCE

1. Wheel maintenance: Grease the wheels annually using high-quality bearing grease.
2. Drawer maintenance: Lubricate the slides semi-annually with high-quality bearing grease.
3. Lubricate the lock with graphite annually.

Blank lined paper with a diagonal watermark reading "MACHINERYHOUSE".



ENVIRONMENT PROTECTION

Recycle unwanted materials instead of disposing of them as waste. All tools, accessories and packaging should be sorted, taken to a recycling centre and disposed of in a manner which is compatible with the environment. When the product becomes completely unserviceable and requires disposal, drain any fluids (if applicable) into approved containers and dispose of the product and fluids according to local regulations.

Imported by

HARE & FORBES
MACHINERYHOUSE

Australian Distributor

Hare & Forbes
Machineryhouse
Sydney - Melbourne
Adelaide - Brisbane - Perth

Ph: 1300 202 200
www.machineryhouse.com.au

MACHINERYHOUSE

New Zealand Distributor

Machineryhouse
Auckland
Christchurch

Ph: 0800 142 326
www.machineryhouse.co.nz